

# 2

- A - ASCENSEUR
- B - MONTE CHARGE
- C - ESCALIER DE SECOURS
- D - TOILETTES H & F
- E - BUREAU DU SYNDIC.

*NIVEAU*

*LUX MALL*

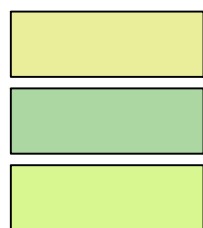
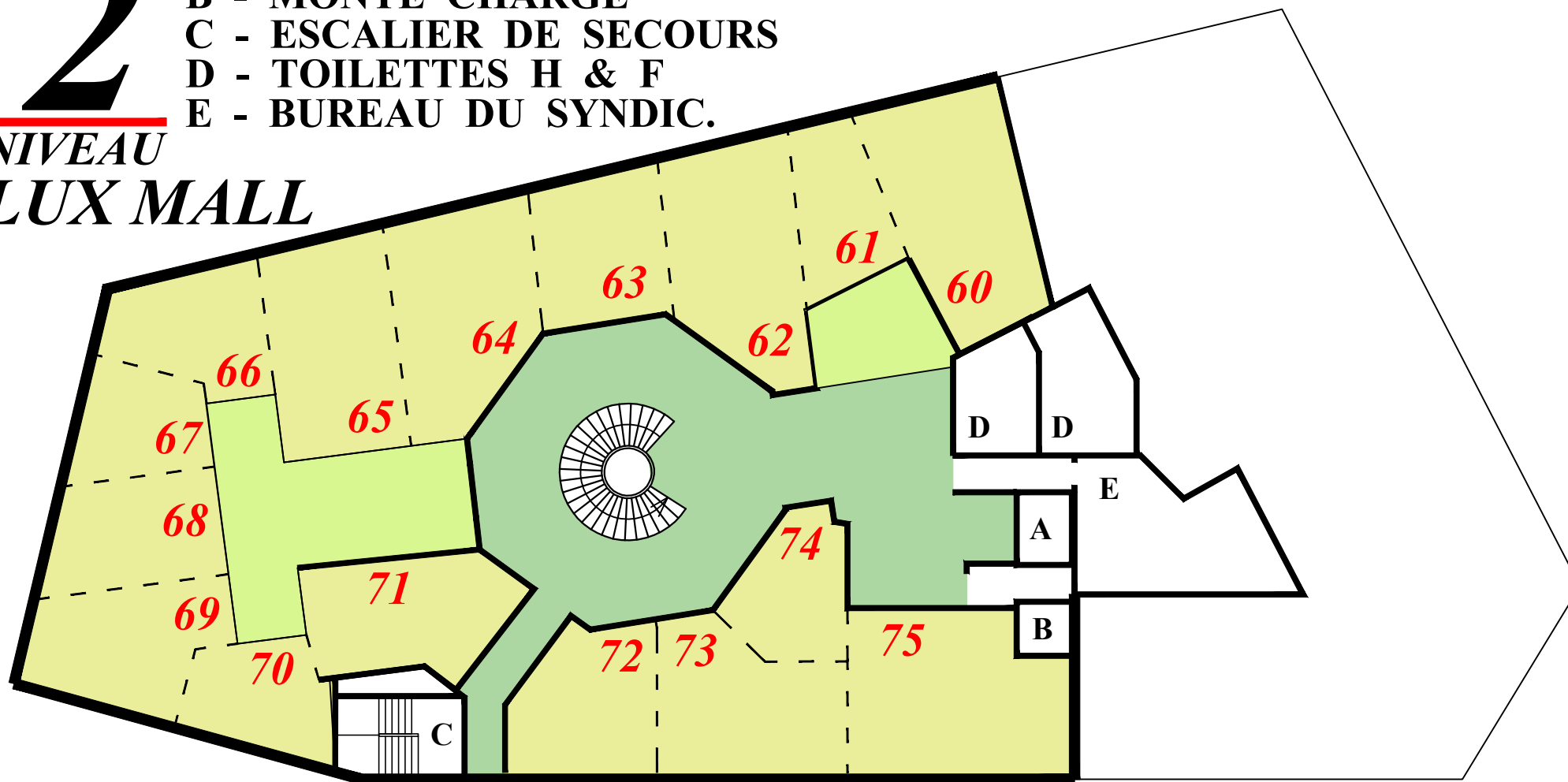

Surface Totale de 60 a 75 = 394 m2

Surface Totale Circulation = 134 m2

Surface Totale a Occuper = 54 m2